

VEDERE "W" PLACA SUPERIOARA Scara 1:10

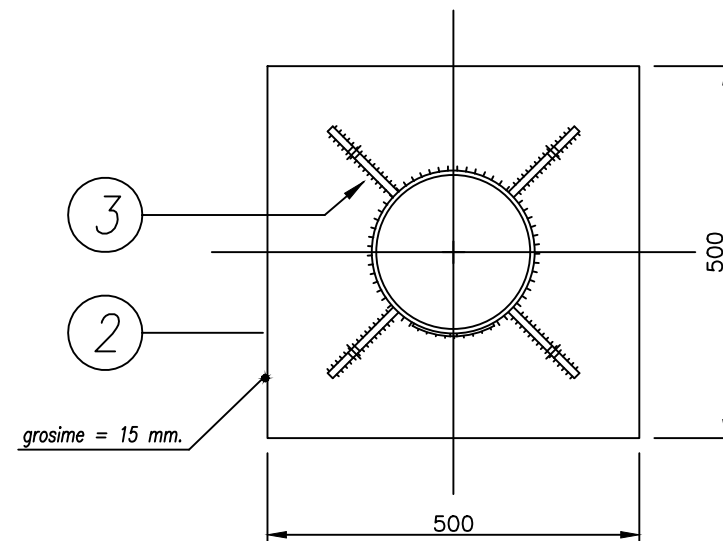

**ATTENTIE !**

-gaurile de fixare a echipamentului electric, din placa superioara, se vor da in functie de tipul acestuia, ce urmeaza a fi achizitionat si montat.

	Extras de piese metalice					
Poz	Denumire element	Dimensiuni (mm)	Bucati	Greutate (kg)		
				/ml	/buc	total
P1	teava rotunda 168x7	2700	1	28.23	76.221	76.221
P2	tabla groasa 500x15	500	1	58.9	29.45	29.45
P3	rigidizare tabla groasa 200x10	90	4	15.7	1.41	5.652
P4	rigidizare tabla groasa 250x10	125	4	19.6	2.45	9.8
P5	tabla groasa 550x15	550	1	64.8	35.64	35.64
	<b>Greutate (kg)</b>					<b>156.76</b>
	<b>Pierderi+sudura (kg)</b>					<b>7.84</b>
	<b>TOTAL (kg)</b>					<b>164.60</b>

NOTA:

- suportul se va proteja anticoroziv prin zincare la cald; grosimea minima a stratului de zinc = 80µm - SR EN ISO 2082-2009;
- sudura se va da pe toata lungimea pieselor metalice in contact, avand a = 0,7tmin, dar nu mai putin de 5mm;
- se utilizeaza otel de uz general S235JR, SR EN 10025-2:2004;
- categoria "B" de executie - STAS 767/0-88;
- nivelul "C" de acceptare al imbinarilor sudate - normativ C 150-99;

## Detaliul "1"

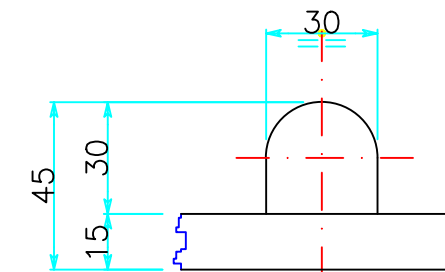

SECTIUNE A-A PLACA DE BAZA Scara 1:10

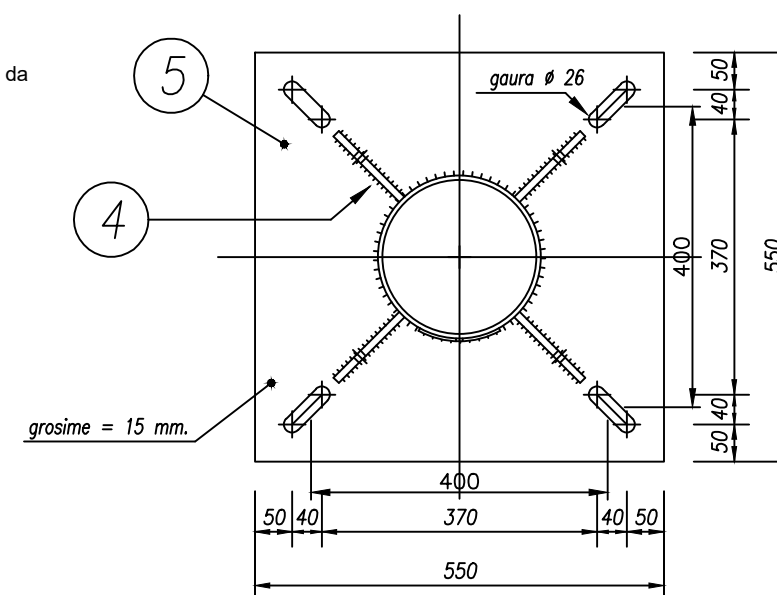



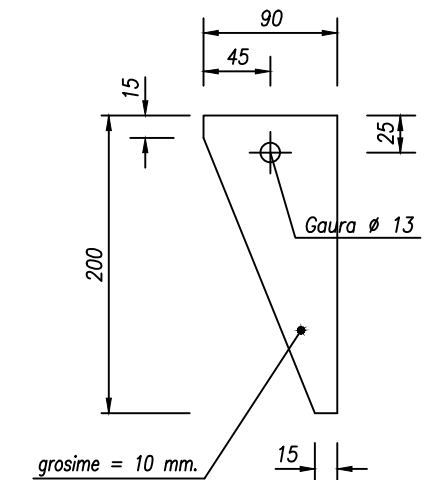

POZITIA. 3 Scara 1:5

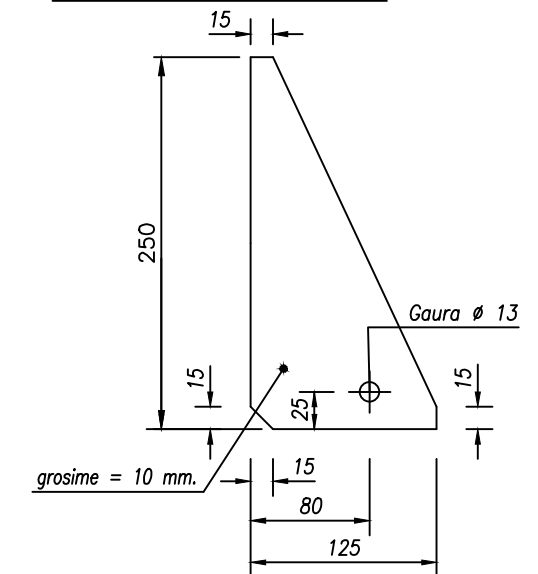

*POZITIA. 4 Scara 1:5*



 <p><b>PROIECTANT SPECIALITATE:</b> <b>AEG ELECTRICCONSULT SRL</b> Bucuresti, Sector 1, Bd Banu Manta 27; J4014022/2023, CUI: RO 3773196 Mobil 0765.057.273, E-mail: ggi-vmatoru@gmail.com</p>		<b>BENEFICIAR: DUNAREA POWER SRL</b>  <b>LOCATIE:</b> jud. Constanta, comuna Topalu, CF 104425, 104493, 106994, 106884, 106872, 106875, 106843, 106874, 105315, 105319, 107007, 105359, 105379, 105219, 105228, 105314, 105190, 105188, 107006, 107008, 105340, 105330, 105385	
<b>SPECIFICATIE</b>	<b>NUME</b>	<b>SEMNATURA</b>	<b>SCARA:</b>
PROIECTAT	ing. ADRIAN NITA		1 : 10
DESENAT	ing. IULIAN DOLAN		<b>DATA:</b>
VERIFICAT	ing. GHEORGHE VINĂTORU		01.2026
		<b>FAZA:</b> DTAC  <b>PLANȘA:</b> IC-08	